

**“Extract from the complete product line”
Fire Protection Devices & Accessories**



SALMEN *components*





Live safely with SALMEN fire protection products



SALMEN components
www.salmen-components.de

There is no doubt about it. Fire protection is essential, whether in public buildings or in the private sphere.

However, the decisive question is with which material, which quality and at which price.

This overview of our fire protection program is intended to provide an orientation and to demonstrate the relevant quality criteria.

Our products are persuasive due to the high-quality materials, attention to functional detail and solid construction. Only these can ensure the long lifetime as well as the optimal protection and usability of the fire protection equipment.

We define ourselves as a competent supplier in the areas of fire protection and safety equipment for buildings. This is exhibited in particular by our certifications such as TS 16949, DIN EN ISO 14001, DIN EN ISO 9001:2008, DIN EN 671-1 as well as all of the welding certificates such as DIN EN ISO 3834 T2

Because not only customer satisfaction but also customer safety is our first priority.

SALMEN components GmbH & Co. KG
Werk Lendringsen (Head Office)
Bieberkamp 63
D-58710 Menden
phone: +49 (0) 2373 / 809-0
fax: +49 (0) 2373 / 809-80
info@salmen-components.de
www.salmen-components.de



Aside from our standard product range, we also provide customized products upon request.

This is a special SALMEN strength.

SALMEN components GmbH & Co. KG
Werk Deilinghofen
Schottlandstraße 6
D-58675 Hemer-Deilinghofen
phone: +49 (0) 2372 / 966-785
fax: +49 (0) 2372 / 966-780
info@salmen-components.de
www.salmen-components.de



We hope you will understand that we cannot assume responsibility for printing errors or other mistakes which can occur despite our utmost care.

SALMEN components GmbH has all copyrights.

No reprints are allowed, even in excerpts, unless explicitly approved by us.

For specific consultations, we will be pleased to be of assistance to you at any time.

Features of Construction and Quality

Hose reel cabinets according to DIN EN 671-1 & DIN 14461-1



Material

Galvanized steel sheet, phosphatized and chromated, rinsed.

The use of galvanized sheet steel in combination with high-quality powder-coating provides effective and long-lasting protection against corrosion.



Features of construction

Cabinet and doors with all-around double folded edges, connections spot-welded, door hinges 80 mm, doors are exchangeable.



Mounting fixture for fire alarm

Push-button

The built-in cabinet for a push-button fire alarm has an adjustable depth and thus allowing the alarm to be flashed with the door. Angle iron for attaching alarm has recessed groove for orderly laying of cable.



Door fastening

According to DIN 14461-1: turn handle of zinc die-casting, chromed, recessed, can be sealed.



Hose reel DIN EN 671-1

Water hose reels with 500, 550, 600 and 650 mm diameter.

Equipped in compliance with DIN EN 671-1, with CE certification by a governmentally recognized testing institute. Height at which reel is mounted is adjustable.

This facilitates the adjustment of the distance between the hose connecting valve and the hose reel when the pipe supply line is inexact.



Axial water supply

Solid brass waterway with double o-ring seal, mounting by split bearing of POM.

Easy adaptation to water pressure, since the ball-shaped housing of the axle does not allow axial forces to set in (no piston effect!)

Tested up to 50 bars.

Wall hydrants according to DIN 14461-1

Hose reel cabinets with semi-rigid rubber hose DN 25 (1") for use by laymen and for the fire brigade in case of fire



Surface cabinet (style C) photo

Type 1-C/30

740 x 840 x 250 mm (w x h x d)

Recessed cabinet (style B) without picture

Type 1-B/30

700 x 800 x 250 mm (w x h x d)



Surface cabinet (style C) photo

Type 1-C/35

900 x 900 x 250 mm (w x h x d)

Recessed cabinet (style B) without picture

Type 1-B/35

860 x 860 x 250 mm (w x h x d)



Combi-surface cabinet (style C) photo

Type 1-C/K-30

1.090 x 920 x 250 mm (w x h x d)

Combi-recessed cabinet (style B) without picture

Type 1-B/K-30

1.050 x 880 x 250 mm (w x h x d)



Combi-surface cabinet (style C) photo

Type 1-C/K-M-30

1.090 x 920 x 250 mm (w x h x d)

Combi-recessed cabinet (style B) without picture

Type 1-B/K-M-30

1.050 x 880 x 250 mm (w x h x d)



Combi-surface cabinet (style C) photo

Type 1-C/K-K-30

1.090 x 920 x 250 mm (w x h x d)

Combi-recessed cabinet (style B) without picture

Type 1-B/K-K-30

1.050 x 880 x 250 mm (w x h x d)



Combi-surface cabinet (style C) photo

Type 1-C/K-K-M-30

1.090 x 920 x 250 mm (w x h x d)

Combi-recessed cabinet (style B) without picture

Type 1-B/K-K-M-30

1.050 x 880 x 250 mm (w x h x d)

Wall hydrants according to DIN 14461-1

Hose reel cabinets with semi-rigid rubber hose DN 25 (1") for use by laymen and for the fire brigade in case of fire



Combi-surface cabinet (style C) photo

Type 1-C/K-LEF-30-SO

740 x 1.090 x 250 mm (w x h x d)

Combi-recessed cabinet (style B) without picture

Type 1-B/K-LEF-30-SO

700 x 1.050 x 250 mm (w x h x d)



Combi-surface cabinet (style C) photo

Type 1-C/K-M-LEF-30-SO

740 x 1.240 x 250 mm (w x h x d)

Combi-recessed cabinet (style B) without picture

Type 1-B/K-M-LEF-30-SO

700 x 1.200 x 250 mm (w x h x d)



Combi-surface cabinet (style C) photo

Type 1-C/K-M-LEF-Q-30-SO

290 x 1.240 x 740 mm (w x h x d)

Combi-recessed cabinet (style B) without picture

Type 1-B/K-M-LEF-Q-30-SO

250 x 1.200 x 700 mm (w x h x d)



Combi-surface cabinet (style C) photo

Type 1-C/HANNOVER-2-BF-4564

1.050 x 1.350 x 250 mm (w x h x d)

Combi-recessed cabinet (style B) without picture

Type 1-B/HANNOVER-2-BF-4563

1.000 x 1.300 x 250 mm (w x h x d)



SALMEN components

Wall hydrants according to DIN 14461-1

Hose reel cabinets with semi-rigid rubber hose DN 25 (1") for use by laymen and for the fire brigade in case of fire

Special-designs



Combi-surface cabinet „Special design“
Type 1-C/K-K-M-LEF-35-E-BS-ESG-SAT-SO
900 x 1.300 x 220 mm (w x h x d)
Manufactured from stainless steel,
material-No. 1.4301
visible surfaces polished grain 240.
Two equal-sized doors consisting entirely
of ESG glass panel „SATINATO“ 6 mm
(frosted glass).



Combi-surface cabinet „Special design“
Type 1-C/K-30-LSF-1T-SO
720 x 1.470 x 220 mm (w x h x d)
with compartment for 2 fire extinguishers
under the hose reel compartment
Special colour: anthracite grey RAL No.
7016, epoxy powder coating, thickness
80 my. Non-standard fitting with multi-
purpose branch pipe DM, connectable,
System Storz.



Central station for fire protection
1.240 x 2.000 x 250 mm (w x h x d)
Manufactured from 1,5 mm galvanized
sheet steel, special colour: white
aluminium RAL 9006 epoxy powder coating,
thickness 80 my. Turn handles of zinc die-casting,
chromed, recessed, can be sealed.
Consisting of 4 different individually
bolted cabinets and upper facing.
Delivery on request with signal-lamp
and a loudspeaker in connection with smoke detector.

Wall hydrants according to DIN 14461-1

Hose reel cabinets with semi-rigid rubber hose DN 25 (1") for use by laymen and for the fire brigade in case of fire

Special-designs



Combi-surface cabinet „Special design“
Type 1-C/K-K-M-30-E-BS-ESG-SO
1.090 x 920 x 250 mm (w x h x d)
made of stainless steel, material-No. 1.4301,
visible surfaces polished grain 240.
Doors and backwall of cabinet consist entirely
of ESG glass panel, 6 mm.



Surface cabinet „Special design“
Type 1-C/30-ESG-SO
740 x 840 x 250 mm (w x h x d)
Door of cabinet consists entirely
of ESG glass panel, 6 mm.



Free-standing cabinet „Special design“
Type 1-C/30-HALBR-FS-AUDI-SO
900 x 900 x 250 mm (w x h x d)
(Dimensions without pipe-frame)
half-round design made of 3 mm steel
sheet, mounted in pipe-frame, colour
black. Door and backwall have round
windows with acrylic glass panels, 4mm.



Free-standing cabinet „Special design“
Type 1-C/35-AF-ACR-SO
900 x 900 x 300 mm (w x h x d)
(Dimensions without mounting-frame)
Front doors with two folding aluminium
frames with 3 mm thick acrylic glass panels.
Provided with toggle lock. Frame with holders
for 3 portable fire extinguishers.



Free-standing cabinet „Special design“
Type 1-C/K-M-LEF-30-2AF-MAK-BS-SO
740 x 1.240 x 280 mm (w x h x d)
(Dimensions without rectangular column frame)
Cabinet made of stainless steel material-No. 1.4301,
visible surfaces polished grain 240.
Front and backwall with folding aluminium frame
with full macrolon glass panel.



Wall hydrants according to DIN 14461-6

Hose reel cabinets for synthetic fire hoses



Surface cabinet (style C) photo

Type 6-C

640 x 740 x 140 mm (w x h x d)

Recessed cabinet (style B) without picture

Type 6-B

600 x 700 x 140 mm (w x h x d)



Combi-surface cabinet (style C) photo

Type 6-C/K-M-12

990 x 920 x 220 mm (w x h x d)

Combi-recessed cabinet (style B) without picture

Type 6-B/K-M-12

950 x 880 x 220 mm (w x h x d)

Wall hydrants according to DIN 14461-2

Cabinets for „dry“ rising fire mains



Combi-surface cabinet (style C) photo

Type E-C/K-M-12

340 x 1.290 x 220 mm (w x h x d)

Combi-recessed cabinet (style B) without picture

Type E-B/K-M-12

300 x 1.250 x 220 mm (w x h x d)



Combi-surface cabinet (style C) photo

Type E-C/K-K-M-12

640 x 740 x 220 mm (w x h x d)

Combi-recessed cabinet (style B) without picture

Type E-B/K-K-M-12

600 x 700 x 220 mm (w x h x d)



Surface cabinet (style C) photo

Type E-C

340 x 440 x 140 mm (w x h x d)

Recessed cabinet (style B) without picture

Type E-B

300 x 400 x 140 mm (w x h x d)



Surface cabinet (style C) photo

Type ESP-C

740 x 740 x 300 mm (w x h x d)

Recessed cabinet (style B) without picture

Type ESP-B

700 x 700 x 300 mm (w x h x d)

Hose and equipment cabinets



Hose and Equipment cabinet

Type TG/A-DO

700 x 1.200/1.250 x 350 mm (w x h x d)

with 2 mandrels for storing

each 3 pcs. synthetic fire hoses size C

(or each 2 pcs. synthetic fire hoses size B)



Hose and Equipment cabinet

Type TG/A-C2

700 x 1.200/1.250 x 350 mm (w x h x d)

with 2 hose reels for storing

each 1 pcs. synthetic fire hose size C



Hose and Equipment cabinet

Type TG/B-DO

1.150 x 1.200/1.250 x 350 mm (w x h x d)

with 4 mandrels for storing

each 4 pcs. synthetic fire hoses size C

(or each 3 pcs. synthetic fire hoses size B)



SALMEN components

Fire extinguisher protection cabinets

All fire extinguisher cabinets also available as built-in models!

Selection: Cabinets galvanized steel sheet – sloped roof



Fire extinguisher cabinet (surface)

Type FL-A/12-G

300 x 730/760 x 220 mm (w x h x d)

for 1 pcs. portable fire extinguisher max. 12 kg

Material: galvanized steel sheet
with sloped roof, door can be sealed

Door fastening: plastic-lever
with spring seal, colour black



Fire extinguisher cabinet (surface)

Type FL-A/D-12-Z

600 x 730/760 x 220 mm (w x h x d)

for 2 pcs. portable fire extinguisher max. 12 kg

Material: galvanized steel sheet
with sloped roof

Door fastening: cylinder-lock with 2 keys



Fire extinguisher cabinet (surface)

Type FL-A/12-Z

300 x 730/760 x 220 mm (w x h x d)

for 1 pcs. portable fire extinguisher max. 12 kg

Material: galvanized steel sheet
with sloped roof

Door fastening: cylinder-lock with 2 keys

Cabinets steel sheet – flat roof



Fire extinguisher cabinet (surface)

Type FS 6-12/0001

340 x 730 x 220 mm (w x h x d)

for 1 pcs. portable fire extinguisher max. 12 kg

Material: steel sheet, with flat roof

Door fastening: turn handle made of
light metal alloy, can be sealed

Fire extinguisher cabinet (surface)

Type FS 6-12/0002

340 x 730 x 220 mm (w x h x d)

for 1 pcs. fire extinguisher max. 12 kg

Material: steel sheet, with flat roof

Door fastening: cylinder-lock with 2 keys

Fire extinguisher protection boxes and fitting systems



SIBO-safety box

Typ FL-SH/6-2-E (for fire extinguisher 6 kg.)
290 x 690 x 200 mm (W x H x D)

Typ FL-SH/12-2-E (for fire extinguisher 12 kg.)
350 x 760 x 230 mm (W x H x D)

Particularly sturdy construction, suitable for trucks, tankers or wall-mounting inside and outside. Mounting plates manufactured from stainless steel, material-No. 1.4301, upper section from transparent polyethylene, weather and temperature resistant, shock and UV resistant.



Fire extinguisher protection boxes

for one fire extinguisher 6 kg. or 12 kg.

- dimensions of box up to 6 kg.:

295 x 640 x 230 mm (W x H x D)

- dimensions of box up to 12 kg.:

345 x 795 x 235 mm (W x H x D)

Material:

Polyethylene, shock proof, UV resistant (recommended for outside use)

- Colours: lower part grey, upper part transparent

- 2 sturdy corrosion-resistant hook clasps, made of stainless steel



Fire extinguisher stand

(without extinguisher)
made of sheet steel
black powder-coating



Special fire extinguisher box

Type D-150-170

Type D-170-190

310 x 675 x 250 mm (W x H x D)

for 6 kg. or 9 kg. fire extinguisher

Box can be mounted horizontally or vertically due to integrated reinforcement!



Protection bar

(without extinguisher)
made of steel pipe
red powder-coating

Dimensions available: (L x H)

Type 1 500 mm x 300 mm

Type 2 750 mm x 300 mm

Type 3 1.000 mm x 300 mm



Fire extinguisher wall holder

for fire extinguishers from 4 kg. to 12 kg.

made of sheet steel, galvanized

or yellow chromed surface



Fire extinguisher stand with ash tray

for one fire extinguisher

6 kg. - 12 kg.

made of stainless steel

dimensions:

overall height 800 mm

cylinder-Ø 245 or Ø 305 mm

clear height: 630 mm

clear width: 200 mm

Also available without ashtray application! Can be used for example as a flower-stand.



Fire extinguisher holder for vehicles

for one fire extinguisher

from 4 kg. to 12 kg.

two models available:

Type HKZ 6/0042 (for 6 kg.)

made of 8 mm wire

Typ HKZ 6-12/0045

(Universal holder)

adjustable from Ø 135-190 mm

Surface protection: iron phosphate treated, black powder-coating



Hose reels and hose reel waggon



Hose reels for cabinets

Typ SHF

disk-Ø: 500, 550, 600, 650 mm
DIN EN 671-1 / DIN 14461-1

for semi-rigid rubber hoses according to DN 25 (1") or DN 19 (3/4") EN 694, made of galvanized steel sheet red RAL 3001 powder-coating. Solid brass waterway with double o-ring seal, mounting by split bearing of POM.

„CE certified“ in accordance with EN 671-1 !



Hose reels for wall mounting

Typ SHF-B (rigid)

disk-Ø: 500, 550, 600 and 650 mm
according to DIN EN 671-1

for semi-rigid rubber hoses according to DN 25 (1") or DN 19 (3/4") EN 694, made of galvanized steel sheet red RAL 3001 powder-coating. Solid brass waterway with double o-ring seal, mounting by split bearing of POM (without connection-hose).



Hose reels for wall mounting

Typ SHF-S (swings out)

disk-Ø: 500, 550 and 600 mm
according to DIN EN 671-1

for semi-rigid rubber hoses according to DN 25 (1") or DN 19 (3/4") EN 694, made of galvanized steel sheet red RAL 3001 powder-coating. Solid brass waterway with double o-ring seal, mounting by split bearing of POM (without connection-hose).



Stationary hose reels

Typ SHF-BR

for ground or wall mounting
disk-Ø: 500 and 600 mm

for semi-rigid rubber hoses according to DN 25 (1") or DN 19 (3/4") EN 694, hose reel made of galvanized steel sheet, red RAL 3001 powder-coating. Solid brass waterway with double o-ring seal, plastic axle bearings. Frame made of molded laminated circular tube, with rotating crank, lightgrey RAL 7035 powder-coating.



Hose reel wagon

Typ SWF-K

disk-Ø: 500 and 600 mm
for semi-rigid rubber hoses according to DN 25 (1") or DN 19 (3/4") EN 694, hose reel made of galvanized steel sheet, red RAL 3001 powder-coating. Solid brass waterway with double o-ring seal, plastic axle bearings.

Tubular transport frame with rotating crank and appliance for fastening, lightgrey RAL 7035 powder-coating. Solid rubber wheels 200 mm circumferenced plastic rim, mounted by plain bearing.



Hose reels for synthetic fire hose

Type C-42 (C-52)

Ø 470 mm
according to DIN EN 671-2
for max. 30 m synthetic fire hose C-42 or C-52
made of galvanized steel sheet red RAL 3001 powder-coating

Fire fighting fittings, Fire hoses and equipment

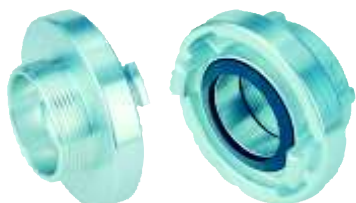

Adapters „STORZ“
with female thread or male thread



Hose couplings „STORZ“
for external binding



Blank caps „STORZ“
with chain



Multi-purpose nozzle
brass chrome plated



Branchpipe
for preventive protection
STORZ System Connection or tail



Spanners for couplings
„STORZ“ System



Landing valves (Fire valves)
with STORZ-adapter



Screw connections with swivel nut
for easier assembly of landing valves
on rising mains.



Building supply fitting
DIN 14461-4
for dry risers



Landing valve
DIN 1461-5 for dry riser



Euro Nozzle
EN 671-1



Fire-fighting hoses
DIN 14811 / Pr EN 1924
Different sizes



Non-kinkable rubber hose
EN 694-A



Fire Extinguisher Cylinders & Accessories



Presentation of 2-part and 3-part cylinders



For almost 4 decades, **SALMEN** has been manufacturing pressure vessels, shells and accessories of steel, special steel and nonferrous metals with a wall thickness of between 0.6 to 4.0 mm. Pressure vessels are produced in 2-part as well as 3-part designs. Depending on the application and visual appearance, our customers require either one of the designs. The following will present you with their special technical features in detail:



2-part cylinder

- 1 round seam on the bottom or center seam
- 1 bead on the bottom
- 0 cross butt welds



3-part cylinder

- 1 round seam on the cover
- 1 longitudinal seam on the jacket
- 1 round seam on the bottom
- 1 bead on the cover
- 1 bead on the bottom
- 2 cross butt welds

Reliability

Two-part cylinders have only one round weld seam. Thus, cylinders with only one weld seam are possible with a length of up to 900 mm. For 3-part cylinders, the jacket length is variable from 250 to 1000 mm. At **SALMEN**, every cylinder is tested for tightness and crushing strength to ensure reliability.

Internal coating

For aggressive extinguishing media, the cylinders are internally coated. This is possible for 2-part cylinders as well as for 3-part cylinders. For risk minimization of beads and weld seams, **SALMEN** coats by thermal rotational sintering with polymeric plastic material in a thick film method of 0.7 to 1.0 mm. For the warranty of absolute tightness, the cylinders are tested by means of electronic resistance measurement. Because of the smaller number of beads and seams, we recommend the 2-part design for internally coated cylinders.

Economic efficiency / safety

Because of the material hardening due to the deep-drawing process, 2-part cylinders are more resistant to shock and impact – thus, a longer service life is ensured, in addition to the increased safety.

The body of 3-part cylinders are produced without drawing tools; thus, intermediate sizes and diameter variants are possible without major tooling expenditures.

Optics

All fire extinguisher cylinders have an attractive design. Weld seam ridges are avoided, and great importance is attached to perfect powder coating. Aside from their innovative and attractive design, 2-part cylinders allow all exits to be planned without offending weld seams. Three-part cylinders have a high market share and are generally used, whereas 2-part cylinders – because of their invisible weld seams - are more and more frequently seen in areas which are open to the public.

Manufacturing possibilities

SALMEN manufactures 2-part and 3-part cylinders of up to 400 mm diameter and 900 mm length. Up to 5 progressive presses with 125 tons pressing force each are available for this, as well as rounding equipment for up to 1000 mm length. On automated assembly lines, we handle circumferential and longitudinal welding, spot welding, clinching, clinch riveting and bonding, as well as brazing of valves and neck rings. On the assembly line, the cylinders are also stamped, and the 100% pressure test is carried out. Surface protection is performed in several powder coating systems with upstream degreasing, washing, and iron phosphatizing.

We will be pleased to be of assistance with your applications. Give us a challenge!



Technical details

Excerpt from the standard program

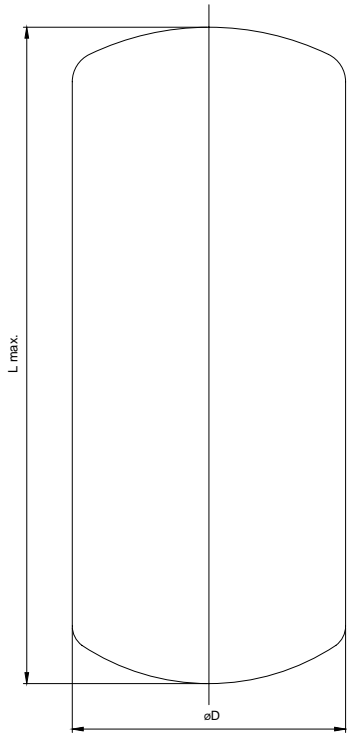

øD	Max. length	Max. volume cm	Head forms				Bottom forms					
			1	2	3	4	1	2	3	4	5	
85	231	1250	x			x		x				
90	205	1050	x			x		x				
95	300	2150	x			x		x				
100	315	2150	x					x				
110	305	2600	x	x		x		x		x		
125	362	3600	x	x	x	x				x	x	
150	435	7000	x	x	x	x	x		x	x	x	
160	443	7600	x	x	x	x	x		x	x	x	
180	522	11200	x	x	x	x	x		x	x	x	
185	458	11000	x	x	x	x	x		x	x	x	
190	565	14000	x	x	x	x	x		x	x	x	

Head forms

Bottom forms

H 1

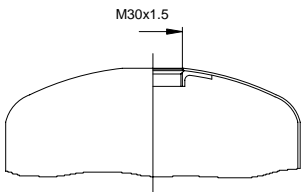

H 2

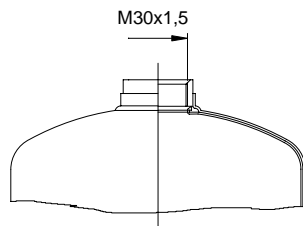

H 3

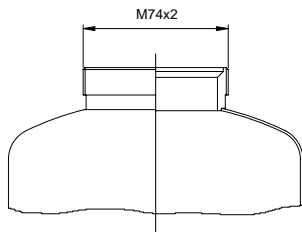

H 4

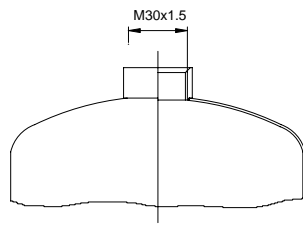

B 1

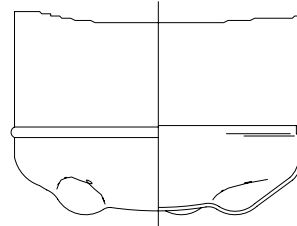

B 2

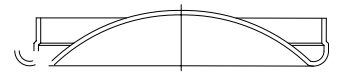

B 3

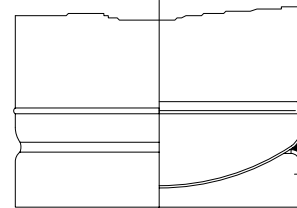

B 4

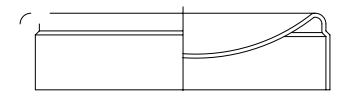

B 5

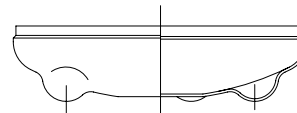

Technical details

Stamping

<div style="border: 1px solid black; padding: 5px; display: inline-block;"> XXXXX VXX,X XX,XX F PTXX PSMAX XX TS -30 / +60°C CE0036 SC XX/XX X / XX </div>											
1	2	3	4	5	6	7	8	9	10	11	12
<ol style="list-style-type: none"> 1. Serial number (5 digits) 2. Volume (l) 3. Net weight of cylinder (kg) 4. Only for fire extinguishers 5. Pressure test (acc. to drawing) 6. Max. operating pressure (acc. to drawing) 7. Temperature range 8. Approval number 9. Manufacturer's mark 10. Date of manufacture (month/year) 11. Customer ID (if requested) 12. Year of retesting (only stored-pressure-extinguishers in D and NL) 											
Any transmission, as well as duplication, utilization and disclosure of the contents of this document shall be prohibited, unless explicitly approved in writing. Any breach thereof results in damage claims and may have criminal law consequences (§18 UWG - (law Against Unfair Competition); § 106 UrhG - (Copyright Law). Reservation of ownership and all rights, even for granting patents and for utility model registration: SALMEN components GmbH, Bieberkamp 63, D-58710 Menden.											
				Changes only permitted with AutoCAD R14		<h3>Marking for CE Vessels</h3> <h2>T 084</h2>					
		Date	18.01.2002								
		Name	Mettken								
		Date									
		Checked									
3	Corrections	22.02.05	Met								
2	TTK inapplicable	29.10.02	Met								
1	Revised	08.07.02	Met								
Rev.	Notification	Date	Name								



Technical details

Excerpt from the standard program

Special vessels for portable and mobile fire extinguishers (steel and stainless steel)

Mobile fire extinguisher trolleys for 25-72 liter volume



Portable special vessels



All products are plastic powder-coated in RAL 3001
All vessels with or without accessories (handles, wheels, etc.)

Mounting systems and other accessories



Universal wire bracket
(depending on cylinder size)

- Diameter: 5 mm and 6 mm
- Application area for 0.5 kg – 4 kg
- Surface galvanized
- 8 - 12 my or plastic coated to 100 my

Plastic footings - for retrofit -
Fits most portable fire extinguishers with and without bumped bottoms.

- Added stability.
- Esthetic design; hides the lower circumference weld of cylinder.
- No gluing necessary.

Material: impact, temperature and UV resistant Polyamide PA 6.6 with optional pistol and CO₂ bottle holders.

K= footing standard
KP= with pistol holder
KPF= with pistol and bottle holder
Color: black, other colors on request



Type K



Type KP

Car holder with textile straps

- For fire extinguishers from 4 - 12 kg
Available in 2 designs:



TYP HKZ 6/0042

Prod. no. 460016
of 8 mm wire



TYP HKZ 6-12/0045

Prod. no. 460048
(universal holder)
adjustable from 135 to 190 mm
Material: 1.25 mm sheet steel

Cylinder Ø	Type	Model no.
150 mm	150-58-K	320008
150 mm	150-58-KP	320006
150 mm	150-58-KPF	320010
160 mm	160-60-K	320002
160 mm	160-60-KP	320003
180 mm	180-68-K	320020
180 mm	180-68-KP	320007
185 mm	185-65-K	320001
185 mm	185-65-KP	320024
185 mm	185-65-KPF	320009
190 mm	190-72-K	320005

Surface protection: iron-phosphatized,
black powder coated

Safety ashtrays and waste bins



Steel and stainless steel wall-mounted ashtrays



Floor model ashtray "DIABOLO"



Waste bin "FIRE - EX"

Floor model ashtray combination



For further information about these products, please see our brochure:
Handy products for workshop, organization and safety



SALMEN components

SALMEN components GmbH & Co. KG

Werk Lendringsen (Head Office)

Bieberkamp 63

D-58710 Menden

phone: +49 (0) 2373 / 809-0

fax: +49 (0) 2373 / 809-80

e-mail: info@salmen-components.de

www.salmen-components.de

SALMEN components GmbH & Co. KG

Werk Deilinghofen

Schottlandstraße 6

D-58675 Hemer-Deilinghofen

phone: +49 (0) 2372 / 966-785

fax: +49 (0) 2372 / 966-780

e-mail: info@salmen-components.de

www.salmen-components.de

